

LOT SIZE: APPROX. 2.13 ACRES
BUILDING SIZE: 25,429 SF
YEAR BUILT: 1924 & 2003
ZONING: PUD, NEIGHBORHOOD RETAIL W/ EVENT CENTER

Be a part of the Muse Meridian community!

Small or large spaces available with flexible short term leases. Grow your business with a professional Mid-town location close to Friends University and Newman.



PROPERTY HIGHLIGHTS

- Multiple spaces available for lease in this intentionally inspired commercial building.
- One acre corner land for outdoor events &/or future expansion.
- Prime midtown service area just North of Kellogg/US-54/KS 400 on Meridian Avenue by Friends University and Newman University.
- Mixed uses and diversification.



METRO MERIDIAN PLANNED UNIT DEVELOPMENT - P.U.D.#98

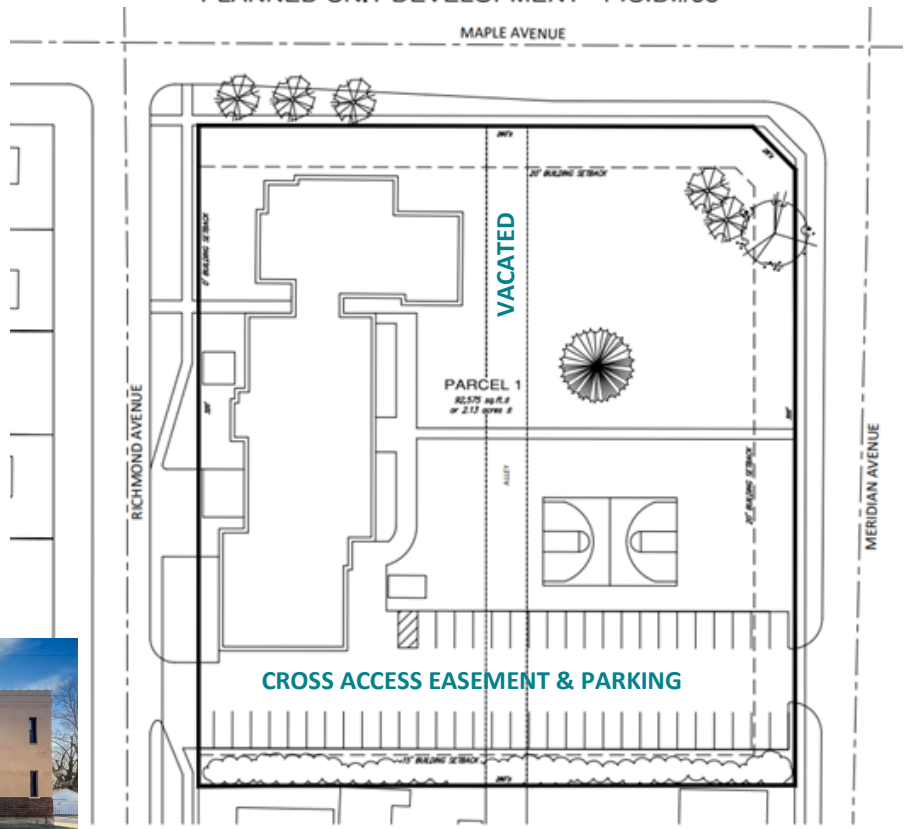



SUITE	SQ. FT.	DESCRIPTION
100	897	Admin Office w/ Private Office
100A	NA	Principal's Office
101	NA	Front Office
102	850	Classroom plus kitchenette
103	879	Standard Classroom
104	820	Classroom 104&105 combined
105	774	Class w/ kitchenette & bathroom
106	225	Private Office
108	325	Private Office, Private Entrance
109	950	Private Office, Private Entrance
112	2400	Gym/ Event Center & Backstage
113	1200	Science Lab
200	759	Standard Classroom
201	450	Counselors Office
202	759	Standard Classroom
203	876	Standard Classroom
204	816	Standard Classroom
205	776	Standard Classroom
206A	849	Standard Classroom— can combine
206B	704	Standard Classroom— can combine
207	795	Standard Classroom

